



*Use and care guide*  
Sanitizing System



LSR100

LBU100





  
lotus®

## Important Safeguards

- ✓ READ ALL INSTRUCTIONS carefully before operating your lotus<sup>®</sup> Sanitizing System.
- ✓ To protect against electrical shock do not immerse cord, plugs and/or system in water or other liquid.
- ✓ Keep out of reach of children. Close supervision is necessary when used by or near children.
- ✓ Remove plug outlet from wall when your lotus<sup>®</sup> is not in use.
- ✓ Do not operate your lotus<sup>®</sup> if it is dropped or damaged in any manner.
- ✓ Use only lotus<sup>®</sup> supplied attachments. Use of attachments not manufactured or sold by Tersano (International) SRL may cause injuries.
- ✓ Do not allow cord to hang over a counter top or tabletop or touch hot surfaces.
- ✓ Do not use attachments in a microwave oven.
- ✓ Do not place your lotus<sup>®</sup> on or near any hot surfaces.
- ✓ Do not use your lotus<sup>®</sup> for any other purpose except as intended and instructed in this Use and Care Guide. Your lotus<sup>®</sup> Sanitizing System is designed for normal household use and NOT intended for commercial use.

**SAVE THESE INSTRUCTIONS**

**For Household Use Only**

Product may vary slightly from illustrations enclosed in this Use and Care Guide

## Caution

- ⓘ Keep Out of Reach of Children.
- ⓘ For use only with attachments provided by Tersano. Ensure the correct mode is used with the corresponding attachment.
- ⓘ Do not remove any sanitizing attachment until the sanitizing cycle is complete. Doing so could damage the unit.
- ⓘ Do not use rough cleansers, steel wool pads or other abrasive materials on your Sanitizing System or attachments.
- ⓘ Keep your system away from heat sources or open flames.
- ⓘ Do not place any other liquid in the sanitizing attachments, apart from municipally treated drinking water, potable water or bottled water. It may be necessary to use filtered or purified water, in some locations.
- ⓘ Do not use this product if it has a damaged cord or plug, if it is not working properly, if it has been dropped or damaged, or dropped into any liquid, or in the event that you see excessive bubbles in the attachment during processing or smell a strong overwhelming ozone smell coming from your unit please call 1-800-808-1724 for a return authorization to have the unit inspected and repaired or replaced. Do not try to self-repair, as this will invalidate your warranty.

# Table Of Contents

Introduction .....	1
Product Features .....	2
lotus <sup>®</sup> uses in your Home .....	3
Preparing lotus <sup>®</sup> for use .....	4
Using the Spray Bottle .....	5 - 9
Using the Produce Bowl .....	10 - 14
Caring for your lotus <sup>®</sup> Sanitizing System .....	15
Replacing your lotus <sup>®</sup> Booster Cartridge .....	15 - 16
Frequently Asked Questions .....	17 - 18
Troubleshooting .....	19 - 20
Limited Product Warranty .....	21 - 23

## *Introduction*

Congratulations on your purchase of the revolutionary new lotus® Sanitizing System from Tersano™.

Have you ever wondered why the air smells so fresh and clean after a thunderstorm? Well, the reason is that the air has been cleaned and sanitized by the super-oxygen that forms when electricity is discharged through lightning.

The lotus® Sanitizing System uses patented Oxyshield® technology to create a mini electrical discharge to super-oxygenate ordinary tap water and create one of the most powerful commercially available sanitizing agents. Tersano™ engineers have discovered a way to harness the sanitizing power of Mother Nature and make it available to you.

Tersano selected the cutting-edge Oxyshield® technology to be at the heart of your lotus® Sanitizing System because of the powerful and effective sanitizing characteristics of super-oxygenated water.

### *What is super-oxygenated water?*

Super-oxygen molecules contain three oxygen atoms ( $O_3$ ) and are formed when ordinary oxygen molecules ( $O_2$ ) are forced to take on a third oxygen atom ( $O$ ) via our Oxyshield® water infusion process.

### *How does super-oxygenated water work?*

The power of super-oxygenation comes from the unstable nature of the ( $O_3$ ) molecule – the third oxygen atoms tend to consistently break apart from the super-oxygen molecules contained in the water creating a powerful sanitizer.

### *Why does super-oxygenated water work?*

When you expose bacteria and toxins to super-oxygenated molecules, they begin absorbing them immediately. The super-oxygen molecules break apart within seconds and when they do, the bacteria and toxins quite literally explode.

### *Is super-oxygenated water safe?*

Over three years of research and testing has enabled us to develop a method to contain the sanitizing force of super-oxygen molecules in water. After doing their sanitizing work, the super-oxygen molecules found in your Oxyshield® processed water revert back to nothing more than simple oxygen. What's more, healthy cells are left unaffected because of their protective enzyme coating.

You now have the power of Mother Nature at your fingertips to effectively remove bacteria and toxins without the use of harmful chemicals. Your lotus® Sanitizing System also comes with many different attachments to help you with your many sanitizing needs – just mix and match your accessories as and when the need arises.

Please feel free to enjoy the power of the super-oxygenated water that your new lotus® Sanitizing System will deliver for many years to come.

Your friends at Tersano (International) SRL.

# Product Features

Actual appearance of items may vary slightly from what is shown



# Control Panel

- Start/Cancel/Reset Button
- Attachment Selector Button
- Mode Indicator
- Mode Indicator
- Replace Water Symbol
- Replace Filter Indicator

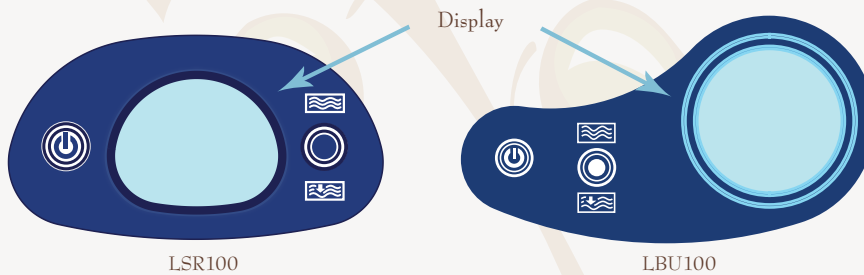

# Booster Cartridge & Reservoir Cap



# lotus<sup>®</sup> some suggested uses in your Home

Rooms of the House	Attachment	Suggestions for use
<b>Kitchen</b>	lotus <sup>®</sup> Multi-Purpose Bowl and Lid	<ul style="list-style-type: none"> <li>* Fruits and vegetables</li> <li>* Meat, poultry and seafood</li> <li>* Dish cloths</li> <li>* Sponges and scrubbers</li> <li>* Utensils</li> </ul>
	lotus <sup>®</sup> Spray Bottle Attachment & Cleaning Cloths	<ul style="list-style-type: none"> <li>* Counter tops and cabinet doors</li> <li>* Sinks and taps</li> <li>* Cutting boards</li> <li>* Stove top, fridge and all appliances</li> <li>* Exterior of fruits and vegetables too large for the bowl</li> <li>* Garbage bins and lids</li> <li>* Plant leaves</li> <li>* Kitchen table and chairs</li> <li>* Baby's high chair</li> <li>* Windows</li> </ul>
<b>Bathroom</b>	lotus <sup>®</sup> Spray Bottle Attachment & Cleaning Cloths	<ul style="list-style-type: none"> <li>* Counter tops and cabinet doors</li> <li>* Sinks and taps</li> <li>* Showers</li> <li>* Mirrors and windows</li> <li>* Garbage bins and lids</li> <li>* Plant leaves</li> <li>* Toilets</li> </ul>
<b>Baby Room</b>	lotus <sup>®</sup> Multi-Purpose Bowl and Lid	<ul style="list-style-type: none"> <li>* Baby toys</li> <li>* Pacifiers</li> <li>* Face cloths</li> </ul>
	lotus <sup>®</sup> Spray Bottle Attachment & Cleaning cloths	<ul style="list-style-type: none"> <li>* Baby mattresses</li> <li>* Change tables</li> <li>* Diaper pails</li> </ul>
<b>Bedroom</b>	lotus <sup>®</sup> Spray Bottle Attachment & Cleaning Cloths	<ul style="list-style-type: none"> <li>* Side tables, mattresses</li> <li>* Mirrors and windows</li> <li>* Plastic and/or metal blinds</li> </ul>
<b>Living Room/ Dining Room/ Rec. Room</b>	lotus <sup>®</sup> Spray Bottle Attachment & Cleaning Cloths	<ul style="list-style-type: none"> <li>* Plant leaves</li> <li>* Tabletops, chairs &amp; sofas</li> <li>* Mirrors and windows</li> <li>* Carpet and upholstery stain removal</li> <li>* Plastic and/or metal blinds</li> <li>* Dog Beds and toys</li> </ul>

\* try it anywhere you use cleaners \*



# Preparing lotus<sup>®</sup> for use

## 1. REMOVE THE RED CENTER RESERVOIR CAP



## 2. Insert the Booster Cartridge into lotus<sup>®</sup> before use.

a. Remove the Booster Cartridge from the plastic bag.

b. Insert the Booster Cartridge into your lotus Sanitizer and apply slight pressure to ensure a snug fit. The Booster Cartridge only inserts into the unit in one direction. Refer to diagram 2b for insertion of the Booster Cartridge for the specific model.



## 3. Plug your lotus<sup>®</sup> in.

4. The Display will briefly light up, flash blue and go into sleep mode, ready for use when you need it.

5. Before use it is important to condition your lotus<sup>®</sup> by processing one cycle of tap water.

a. Select and fill any attachment with cold tap water to the max fill line.

b. Place the attachment on the unit.

c. Press the Attachment Selector Button to choose the symbol on your Display that matches the one found on your attachment.

d. Press the Start/Cancel/Reset Button.

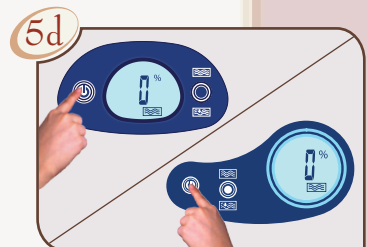
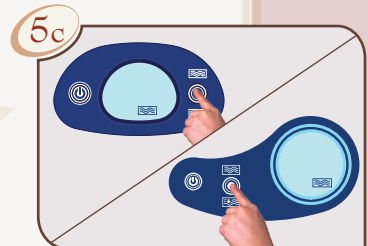

**TIP:** Once the conditioning cycle is complete, give your plants a drink of oxygen-rich water or pour the water into your sink to sanitize it.



**NOTE:** The mode symbol is found on the lid of the bowl or the spray nozzle of the spray bottle.

# Using the Spray Bottle

1. Plug in the lotus® Sanitizing System.



2. Fill the Spray Bottle to the max fill line with cold tap water and screw the top back on. Water must be cold and not just room temperature.



3. Place the Spray Bottle onto the docking portal and firmly push down.



**NOTE:** The direction the Spray Bottle is facing doesn't matter.

4. Press the Attachment Selector Button to choose the symbol on your Display that matches the one found on the top of your Spray Nozzle (wavy lines). Pressing the Attachment Selector Button toggles between the two symbols on the Display.

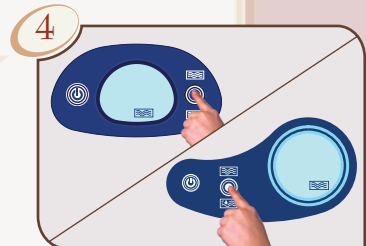

5. Press the Start/Cancel/Reset Button to initiate the process and cause the water to circulate through the main base unit and be activated by patented Oxyshield® technology.

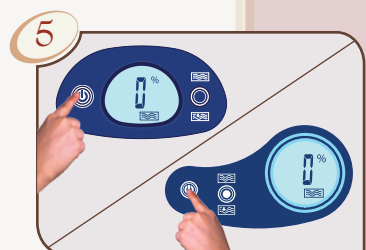

**CAUTION:** Do not remove the attachment until the cycle is complete. Removal of the attachment during processing could damage the unit.



**NOTE:** Do not tilt base upside down. The water in the blue reservoir is perfectly normal and should not be drained unless unit is being shipped.

## Using the Spray Bottle

6. The cycle is complete when you hear an audible beep and see 100% on the Display.



7. Your Spray Bottle now contains Oxyshield® enriched water and is ready to use on surfaces you would like to sanitize or areas you would like to deodorize.



**NOTE:** The first two sprays from the Spray Bottle will not contain Oxyshield® activated water. Also, please remember that it is normal for the base of the unit to be warm during operation.

8. Use the Spray Bottle in conjunction with the lotus® Cleaning Cloths included with lotus® to sanitize surfaces without toxic cleaning chemicals.



9. You now have 15 minutes worth of Oxyshield® activated water before it begins to revert back to Oxygen and normal tap water.

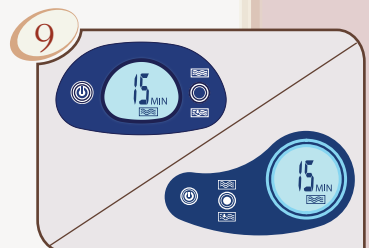

**TIP:** Use your Spray Bottle to deodorize where your pets sleep.

## Using the Spray Bottle

10. At “10 minutes” from the start of the countdown there will be a single beep indicating “5 minutes” of Oxyshield® activated water left.

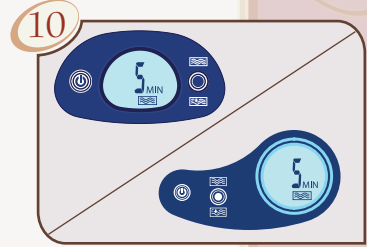

11. After “15 minutes” you will hear a single beep and the Display will show “End” for an additional 5 minutes, after which it returns to the start screen. “End” indicates that the water in the spray bottle has now begun to revert back to normal tap water. To continue sanitizing, re-fill the Spray Bottle and start the process again as required. (Steps 2 through 11)

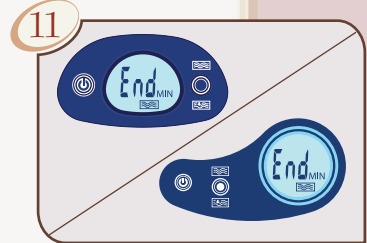

*Bonus Feature:* For heavily soiled or contaminated areas use the lotus® pour spout to pour the super oxygenated water on desired area.



**TIP:** See lotus® Uses In your Home for suggestions (Page 3).



## Using the Spray Bottle (Tips and Techniques)



### deodorizing

1. Follow the steps to create Oxyshield® activated water. (steps 2 through 11).
2. Using the Spray Bottle, turn the spray nozzle clockwise until you are able to get a mist and spray the area you wish to deodorize thoroughly.



### stain removal (coffee, wine, soda etc.)

1. Follow the steps to create Oxyshield® activated water. (steps 2 through 11).
2. Using the Spray Bottle, turn the nozzle counter-clockwise until you get a heavy stream. Spray the stain with a heavy stream or use the pour spout so the Oxyshield® activated water saturates and penetrates the fibers.



**TIP:** Carpet companies advise that you never rub any stains in a circular motion as this will destroy the texture of the carpet.

3. Using a lotus® Cleaning Cloth, blot by pressing down onto the affected area.
4. Continue this process until the stain is lifted. Ensure you rinse the Cleaning Cloth during the process.



## *Using the Spray Bottle (Tips and Techniques)*

5. Use a dry lotus® Cleaning Cloth and blot the affected area to remove excess water.
6. Allow to dry and vacuum.



### *area sanitization*

1. Follow the steps to create Oxyshield® activated water. (steps 2 through 11).
2. Using the Spray Bottle, spray the area thoroughly and use the lotus® Cleaning Cloth to scrub away any excess dirt.
3. Spray the area thoroughly again.
4. Using a lotus® Cleaning Cloth, scrub and clean the area you wish to sanitize.
5. Rinse the area thoroughly using the Spray Bottle and wipe.



### *killing mold & mildew*

1. Follow the steps to create Oxyshield® activated water. (steps 2 through 11).
2. Using the Spray Bottle, spray the moldy area thoroughly and use the lotus® Cleaning Cloth to scrub away any excess mold or mildew.
3. Spray the moldy area thoroughly again.
4. Using a lotus® Cleaning Cloth, scrub and clean the area.
5. Rinse the area thoroughly using the Spray Bottle and wipe.



# Using the Produce Bowl



## fruits and vegetables

1. Plug in the lotus<sup>®</sup> Sanitizing System.



2. Place your fruits and vegetables that you wish to sanitize in the Multi-Purpose Bowl. Fill the Multi-Purpose Bowl halfway with your fruits and vegetables.



**NOTE:** Rinse the fruits and vegetables to remove residues (dirt) prior to processing in the lotus<sup>®</sup> Sanitizing System.

3. Fill the Multi-Purpose Bowl to the max fill line with cold tap water to cover the fruits and vegetables and put the Lid on. Do not fill past the max fill line. (*It is not necessary to fill to the max fill line. Use this as a guide, so you do not over fill.*)



3a. Included in your package is a Vegetable Retainer. Attach the retainer to the lid, ensuring the cylinder is properly inserted into the cavity of the Lid.



*It's easy and simple to have better tasting food.*

## Using the Produce Bowl

4. Place the Multi-Purpose Bowl, Vegetable Retainer and Lid onto the docking portal and firmly push down. The purpose of the Vegetable Retainer is to keep the produce from floating to the top.



**NOTE:** The direction the Multi-Purpose bowl is facing doesn't matter.

5. Press the Attachment Selector Button to choose the symbol on your Display that matches the one found on your Multi-Purpose Lid attachment (wavy lines with an arrow). Pressing the Attachment Selector Button toggles between the two symbols on the Display.

6. Press the Start/Cancel/Reset Button to initiate the process and cause the water to circulate through the main base unit and be activated by patented Oxyshield® technology.



**CAUTION:** Do not remove the attachment until the cycle is complete. Removal of the attachment during processing could damage the unit.

7. The cycle is complete when you hear an audible beep and see "100%" on the Display and then the Display will switch and show "2 minutes". In order to maximize the sanitization of the fruits and vegetables, leave the bowl attachment on the lotus® for this time period.

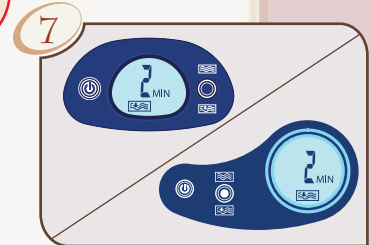
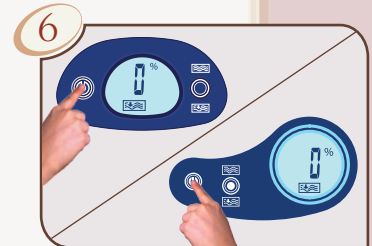
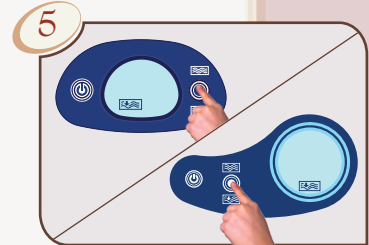



## Using the Produce Bowl

8. After “2 minutes” you will hear a single beep and the Display will show “End” for an additional 5 minutes, after which it returns to the start screen.
9. Once the Display shows “End”, remove the Multi-Purpose Bowl from the base and turn over the sink to drain out the excess water. Your fruits and vegetables are now ready for preparation or storage.



**NOTE:** The unit has a sensor that detects if there is contamination still present at the end of a cycle when processing fruits and vegetables; such as pesticides and other chemicals. When the Replace Water Symbol  shows while sanitizing produce, drain water, replace with fresh water and reprocess a second time.



### *meat, seafood and poultry*

1. Plug in the lotus<sup>®</sup> Sanitizing System.
2. Fill the Multi-Purpose Bowl with cold tap water to the max fill line and cover with the lid.
3. Place the Multi-Purpose Bowl onto the docking portal and firmly push down. Do not put meat, seafood and poultry in the bowl at this time.

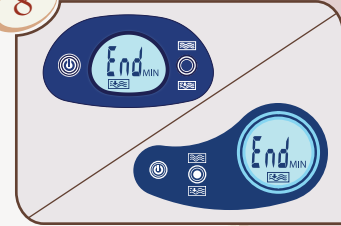

## Using the Produce Bowl

4. Press the Attachment Selector Button to choose the symbol on your Display that matches the one found on your Multi-Purpose Lid Attachment (wavy lines with an arrow). Pressing the Attachment Selector Button toggles between the two symbols on the Display.

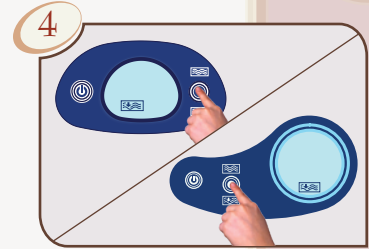

5. Press the Start/Cancel/Reset Button to initiate the process and cause the water to circulate through the main base unit and be activated by patented Oxysshield® technology.

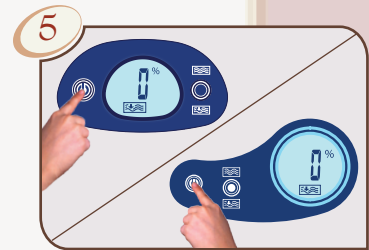

6. The cycle is complete when you hear an audible beep and see 100% on the Display.

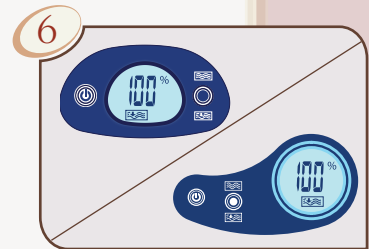

7. Remove the Multi-Purpose Bowl and place on the counter top or in the sink. You will notice the Display will show "2 minutes".



**NOTE:** Pre-rinse all meat, poultry or seafood to remove excess residue prior to processing or spraying.

8. Place the meat, poultry or seafood into the water and leave for the "2 minute" count down shown on the Display.



**NOTE:** Follow same steps as meat and seafood to sanitize rice seeds and small produce.



*Saves you money because you throw away less food.*

## Using the Produce Bowl

9. Once the Display reads “End”, drain the water from the meat, poultry or seafood and begin your food preparation.



**TIP:** Alternatively, if you have a large piece of meat or a turkey, fill the Spray Bottle with cool water, run the cycle to completion and spray the large piece of meat or turkey liberally with activated water. Allow it to remain soaked for two minutes, after which you can prepare your dish as required.



**NOTE:** The lotus<sup>®</sup> Sanitizing System is self-cleansing, so we recommend after processing meat, poultry or seafood to fill the bowl with cold tap water to the max fill line and run a cycle to sanitize the bowl for future use. Alternatively you can cleanse the Multi-Purpose Bowl and Lid with mild soap and warm water.



## *Caring for your lotus<sup>®</sup> Sanitizing System*

Your lotus<sup>®</sup> Sanitizing System is self-cleansing and as such caring for your new system has never been easier. As your attachments cleanse themselves every time you generate Oxyshield<sup>®</sup> activated water, you never have to clean them. However, if you wish to give any attachments an additional cleaning, feel free to do so by placing them on the top drawer of your dishwasher or hand wash with a mild soap and warm water.

- ✓ Always unplug your lotus<sup>®</sup> Sanitizing System prior to cleaning.
- ✓ Only a damp cloth should be used to wipe down your unit.
- ✓ Never immerse your lotus<sup>®</sup> Sanitizing System in water or any other liquid for cleaning.
- ✓ Never use abrasives, detergents or strong cleaning chemicals.

## *Replacing your lotus<sup>®</sup> Booster Cartridge*

Replacing your Booster Cartridge allows you to maximize the sanitizing power of your unit by removing the moisture from the air. All lotus Sanitizing systems have been designed to work effectively at any humidity. However, the Booster Cartridge removes excess humidity in the air allowing the lotus to safely infuse even more super-oxygen into the water. It is the super-oxygen that strengthens the sanitizing force of your lotus<sup>®</sup>.

The Booster Cartridge must be replaced approximately every 90 cycles.

If the Replace Filter Indicator icon is flashing during processing, then there are approximately 10 cycles left before the Booster Cartridge must be replaced.

If the Replace Filter Indicator icon is solid, then the Booster Cartridge must be replaced. It is necessary to reset the filter once the new Booster Cartridge is installed.

Please follow the instructions on page 16 on how to safely replace your Booster Cartridge and reset the Filter Indicator.

# Replace your Booster Cartridge

1. Unplug your lotus® unit.

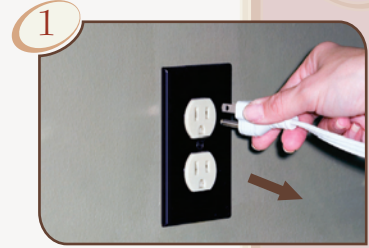

2. Remove the old Booster Cartridge by lifting up and away from the unit.



3. Remove the new Booster Cartridge from the plastic bag.



4. Slide the new Booster Cartridge into place and apply slight pressure to ensure a snug fit.



**NOTE:** The cartridge only slides into the unit in one direction.

5. Plug in your lotus® unit.

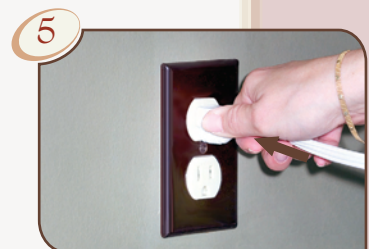

6. Before the unit may be used the filter must be reset. Complete the following to reset the filter:

*Press and hold the Attachment Selector Button for approximately 3 seconds. The unit will beep and the Replace Filter Indicator icon will extinguish. The unit is ready for use. Just press the Start/Cancel/Reset button to begin the cycle.*

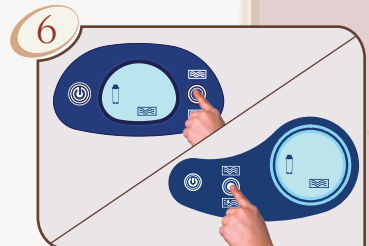

## Frequently Asked Questions



### *What is ORP?*

ORP is a term used frequently in the water treatment and food processing industry. ORP stands for Oxidation-Reduction Potential and is a measure of the oxidizing strength of the water and its ability to break down contaminants.



### *Can I drink the water?*

No. Please use the lotus<sup>®</sup> Water Treatment System for your pure drinking water needs.



### *How do I know if the unit is working and generating Oxyshield<sup>®</sup> activated water?*

Your lotus<sup>®</sup> Sanitizing System was in development for well over three years. The only way that the percentage indicator on the Display can reach 100% is if the water has been fully activated. It is impossible for the indicator to reach 100% without the Oxyshield<sup>®</sup> infusion process being complete.



### *There is water in the center reservoir of my base unit. Is this normal? Should I drain the water from the unit?*

The water in the center reservoir is perfectly normal, as the water is siphoned from the attachment during processing, super-oxygenated and circulated back into the attachment. It is not recommend to drain the water from the base, as this water is already sanitized and the first water to be sanitized on the next cycle. Do not drain the water from the unit, simply insert the red cap received with the unit for storage.



### *Why can't I use the water in the Spray Bottle Attachment after 15 minutes?*

You lotus<sup>®</sup> Sanitizing System infuses ordinary tap water with super-oxygen( $O_3$ ) by utilizing Oxyshield<sup>®</sup> technology to force oxygen molecules ( $O_2$ ) to take on an additional oxygen atom (O). The unstable nature of super-oxygen is what delivers the sanitizing power of lotus<sup>®</sup> and the super-oxygen infused into the water begins reverting back to oxygen after approximately 15 minutes.



### *What happens if I accidentally press the Start/Cancel/Reset Button and there is not a vessel on the base unit?*

Your lotus<sup>®</sup> will determine that something is wrong and the Display will flash with Function Display "F4" accompanied by a series of beeps. Press the Start/Cancel/Reset Button to reset the unit. Fill your attachment to the max fill line with cold tap water, place on the base unit and press the Start/Cancel/Reset Button to initiate the cycle.

## Frequently Asked Questions

- ✔ ***What do I do if I want to change accessories part way through a cycle?***  
If the process has already started and you want to change to a different accessory simply press the Start/Cancel/Reset button to reset the unit. After the attachments have been changed, press your Attachment Selector Button to select the correct mode and press your Start/Cancel/Reset Button again to restart the process from the beginning.
- ✔ ***How long do I have to use the water in the Spray Bottle Attachment before it reverts to normal tap water?***  
You have 15 minutes to use your Spray Bottle after the Oxyshield® processing cycle is complete. Your lotus® Sanitizing System counts down for you and lets you know when the super-oxygen in the water has begun reverting back to oxygen (After at least 15 minutes).
- ✔ ***What type of water should I use with my lotus®?***  
Please use municipally treated, potable or bottled water ONLY. In some locations it may be necessary to use filtered or purified water.
- ✔ ***Can I use warm or hot water in the lotus® Sanitizing System?***  
No. The lotus® Sanitizing System is most effective with cold water.
- ✔ ***Can I just place the fruits and vegetables in the Multi-Purpose Bowl and fill with water?***  
No. Please rinse your fruits and vegetables prior to processing in the lotus® Sanitizing System to remove any excess dirt and residue.
- ✔ ***I want to process my meat, fish or poultry, how do I do this?***  
Fill your Multi-Purpose Bowl with cool water and run the cycle to completion. Pre-rinse all meat, poultry or seafood to remove excess residue prior to processing or spraying. Upon completion, place your meat, fish or poultry into the sanitizing bowl for two minutes. Alternatively, if you have a large piece of meat or a turkey, fill the Spray Bottle with cool water, run the cycle to completion and spray the large piece of meat or turkey liberally with the activated water. Allow it to remain soaked for two minutes, after which you can prepare your dish as required.
- ✔ ***Do I cut my fruits and vegetables before processing?***  
The fruits and vegetables should be placed in the lotus® Sanitizing System whole. The lotus® Sanitizing System removes the harmful bacteria from the outside of your fruits and vegetables. Many fruits and vegetables are grown at ground level and the outer skin may be contaminated. The contamination is automatically transferred to the edible portion of your fruits and vegetables by the knife when you cut them. Therefore always process your fruits and vegetables whole for the most effective sanitizing.

# Troubleshooting

Function Code	Why This Happens	Solution
	<p>Unit has a sensor that detects if there is contamination such as bacteria, pesticides and other chemicals still present at the end of a cycle when processing fruits and vegetables. Those most contaminated include berries, cherries, spinach and peaches.</p>	<p><b>Always rinse visible dirt off before processing.</b> Reset the unit by pressing the Start/Cancel/Reset Button. Check the Booster Cartridge for expiration (indicator eye is green) Change if expired. When the Replace Water Symbol shows while sanitizing produce, drain water, replace with fresh water and reprocess a second time. <b>MAKE SURE WATER IS COLD.</b> If you receive the Replace Water Symbol with just water call your lotus® Customer Care Representative at 1-800-808-1724 for further assistance.</p>
F3	<p>Accessory has been removed during the processing cycle.</p>	<p>Reset the unit by pressing the Start/Cancel/Reset Button. Ensure that the attachment contains water to the max fill line and is securely placed back on the base unit. Reselect the appropriate attachment symbol from the Display and start processing by pressing the Start/Cancel/Reset Button.</p>
F4	<p>Insufficient or no water in accessory.</p> <p>If you receive an F4 repeat the above steps.</p>	<p>Reset the unit by pressing the Start/Cancel/Reset Button. Remove the attachment and ensure it contains water to the max fill line. Securely place on the base unit pressing down firmly. Select the appropriate attachment symbol from the Display and start processing by pressing the Start/Cancel/Reset Button. This may occur if you have turned the unit upside down to drain the water from the unit.</p>
 (Flashing)	<p>Approximately 10 cycles left on your Booster Cartridge</p>	<p>Purchase replacement Booster Cartridge's in preparation for expiration of the existing one.</p>



# Troubleshooting

<i>Function Code</i>	<i>Why This Happens</i>	<i>Solution</i>
 (Solid)	<i>Booster Cartridge is Expired</i>	<p>Unplug the unit from the power outlet</p> <p>Remove the old Booster Cartridge by lifting up and away from the unit. Remove the new Booster Cartridge from the plastic bag.</p> <p>Slide the new Booster Cartridge into place and apply slight pressure to ensure a snug fit. Plug in your lotus® unit. Press and hold the Attachment Selector Button for approximately 3 seconds. The unit will beep and the Replace Filter Indicator light will extinguish. The unit is ready for use</p>
F6	<i>Pump current.</i>	<p>Reset the unit by unplugging from the power outlet. Let the lotus® sit for 5 minutes. Fill the attachment to the max fill line. Place on the unit and press the Start/Cancel/Reset Button.</p>
F7	<i>Voltage Signal</i>	<p>Reset the unit by unplugging from the power outlet. Let the lotus® sit for 5 minutes. Fill the attachment to the max fill line. Place on the unit and press the Start/Cancel/Reset Button.</p>
All Other “F” Codes	<i>Internal diagnostic message detected.</i>	<p>Your lotus® Sanitizing System is equipped with a sophisticated processor to continuously monitor the performance of its internal electronics and ensure that your unit is running at maximum efficiency. Please contact the lotus® Customer Care Department (1-800-808-1724) for the interpretation of this code in the unlikely event that it occurs.</p>

*If none of the above offered solutions resolves your particular situation, please feel free to call your lotus® Customer Care Department at 1-800-808-1724, and speak with a representative who will be more than happy to assist you.*

## Limited Product Warranty

TO THE EXTENT ALLOWED BY APPLICABLE LAW, THE FOLLOWING LIMITED WARRANTY FOR THE LOTUS® SANITIZING SYSTEM (THE PRODUCT) IS EXCLUSIVE AND IN LIEU OF ALL OTHER ORAL OR WRITTEN REPRESENTATIONS, CONDITIONS OR WARRANTIES, WHETHER EXPRESS OR IMPLIED, AND WHETHER ARISING BY LAW, STATUTE, COURSE OF DEALING OR USAGE OF TRADE, INCLUDING BUT NOT LIMITED TO, IMPLIED WARRANTIES AND CONDITIONS OF MERCHANTABILITY, QUALITY, DURABILITY AND/OR FITNESS FOR A PARTICULAR PURPOSE.

### ✓ WHAT DOES THE WARRANTY COVER?

*We, Tersano (International) SRL, warrant that the Product, at the time of shipment to you, the Purchaser, is free from defects in material and workmanship.*

*This warranty gives you specific legal rights, and you may also have other rights which vary from jurisdiction to jurisdiction.*

### ✓ WHAT DOES THE WARRANTY NOT COVER?

*To the extent allowed by applicable law, our obligation to repair or replace the Product or refund the purchase price of the Product, shall be the full extent of our liability for breach of warranty.*

*Our liability with respect to any material not of our manufacture shall be limited to the liability assumed by the vendor(s) of such material.*

*Repairs to, alteration of, or work done on the Product warranted by us but without our prior written authorization shall void our warranty on the Product.*

*To the extent allowed by applicable law, this warranty is not transferable and will automatically terminate if the original Product owner/consumer sells or otherwise disposes of the Product.*

## Limited Product Warranty

*This warranty does not provide protection against, and we will have no liability under this warranty if:*

- ✓ a. *the Product is subject to improper handling or use;*
- ✓ b. *the Product has not been installed, used or maintained in accordance with normal practice and in conformity with our recommendations and published specifications and this consumer manual;*
- ✓ c. *the Product is employed for other than normal household use. Normal household use does not include commercial or rental use of any type.*

### ✓ **WHAT IS THE PERIOD OF COVERAGE?**

*This Limited Warranty is valid for one year from the date of your purchase of the Product as shown by the sales receipt.*

*Some jurisdictions do not allow limitations on how long any implied warranty lasts, so the above limitation may not apply to you.*

### ✓ **WHAT DO WE DO TO CORRECT ANY PROBLEMS?**

*At our option, we shall repair or replace the Product or refund the purchase price of the Product for any warranty claim made within one year of the date of your purchase of the Product as shown by the sales receipt.*

*We will complete any repair, replacement or refund in a reasonable amount of time, but in any case within thirty (30) days of our receipt of the Product.*

### ✓ **WHAT YOU MUST DO?**

*You must keep your sales receipt as proof of the date of purchase.*

*Upon discovery of a defect, you must notify us in writing at Tersano (International) SRL, 3-23 Hannover Drive, St. Catharines, Ontario, L2W 1A3, within thirty (30) days of discovery of the defect of any claim whatsoever that you may have with respect to the Product. Failure to give such notice within the specified time shall constitute an unqualified acceptance and waiver of all claims with respect to the Product.*

*Upon receipt of written notice from you of the nonconforming Product, we, at our option, may inspect the Product at your location or require that the Product be returned to us at your cost and insured risk to our designated location.*

# Limited Product Warranty



## EXCLUSIVITY OF REMEDY: LIMITATION OF LIABILITY

TO THE EXTENT ALLOWED BY LAW THE REMEDIES PROVIDED FOR IN THIS WARRANTY SHALL CONSTITUTE THE SOLE RECOURSE OF YOU AGAINST US FOR BREACH OF ANY OF OUR OBLIGATIONS UNDER OUR AGREEMENT WITH YOU, WHETHER THE CLAIM IS MADE IN TORT OR IN CONTRACT, INCLUDING CLAIMS BASED ON WARRANTY, NEGLIGENCE, STRICT LIABILITY, DECEIT, FRAUD, MISREPRESENTATION, OR OTHERWISE.

TO THE EXTENT ALLOWED BY APPLICABLE LAW, IN NO EVENT SHALL WE BE LIABLE FOR SPECIAL, EXEMPLARY, PUNITIVE, INDIRECT, INCIDENTAL OR CONSEQUENTIAL DAMAGES (REGARDLESS OF THE FORM OF ACTION, WHETHER IN CONTRACT OR IN TORT, INCLUDING NEGLIGENCE), NOR FOR LOST PROFITS, NOR SHALL OUR LIABILITY FOR ANY CLAIMS OR DAMAGE ARISING OUT OF OR CONNECTED WITH OUR AGREEMENT OR THE MANUFACTURE, SALE, DELIVERY OR USE OF THE PRODUCT EXCEED THE PURCHASE PRICE OF THE PRODUCT.

*Some jurisdictions do not allow the exclusion or limitation of incidental or consequential damages or certain types of damages, so the above exclusions or limitations may not apply to you.*

## WARRANTY REGISTRATION AND CONTACTING US

*For Warranty Registration, please:*

- 1) Go to our website: [www.tersano.com](http://www.tersano.com),
- 2) E-mail us at: [wecare@tersano.com](mailto:wecare@tersano.com), or
- 3) Mail us at: **Tersano (International) SRL**  
100 Sonwil Drive  
Buffalo, NY  
14225

*You are encouraged to register the warranty but please be advised that failure to register will not void the warranty.*

*If in North America, please call 1-800-808-1724*

*EPA Est. No. 82126-CHN-001*